

# FOPO

## Portable Monitor

S12



# USER GUIDE

————— Triple Portable Monitor —————

7/24 Tech. Support: ✉ [fopo@afterservice.vip](mailto:fopo@afterservice.vip)

Get 24/7 assistance at



Use camera or QR scanner to scan

Or Visit: <https://fopo.afterservice.vip>

# Contents

1. Overview -----	1
2. Package Contents -----	2
3. Inputs and Buttons -----	3
4. Set It Up -----	5
5. Connect the Monitor with Your Laptop -----	6
6. Choose Your cables -----	7
7. Connection Methods -----	8
7.1 Two Type-C or Thunderbolt 3 Ports -----	8
7.2 One Type-C and One HDMI Port -----	10
7.3 One HDMI Port -----	11
8. Laptop Display Configuration -----	12
8.1 PC/WINDOWS -----	12
8.2 MAC -----	13
9. OSD Function Introduction -----	14
10. OSD Setting -----	15
11. Supported Brands & Models -----	18
12. Tech Specs -----	22
13. Cleaning & Maintenance -----	23
14. Contact Us -----	24

# 1. Overview

## Triple Monitor

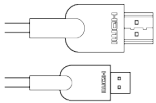
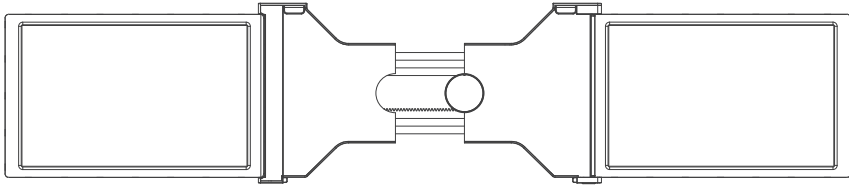

2\*Mini HDMI to  
HDMI Cables  
**VIDEO ONLY**

2\*USB-C to USB-C  
(90-degree) Cables  
**VIDEO & POWER**

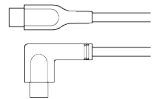

1\* Hook-and-loop  
Fastener

2\*USB-C to USB-A  
Cables  
**POWER ONLY**

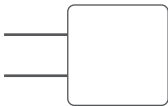
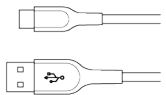

1\*Power Adapter

## 2. Package Contents

- 1\* Portable Triple Monitor
- 2\* Type-C Cables
- 2\* HDMI Cables
- 1\* Cleaning Cloth
- 2\* Screen Protector
- 1\* Power Adapter
- 1\* Hook-and-loop Fastener

**Note:**

Please kindly check out all the accessories in the package. If you find anything missing here, please don't hesitate to contact us via the email address **[fopo@afterservice.vip](mailto:fopo@afterservice.vip)** and we will help you solve the problems as soon as possible.

### 3. Inputs and Buttons

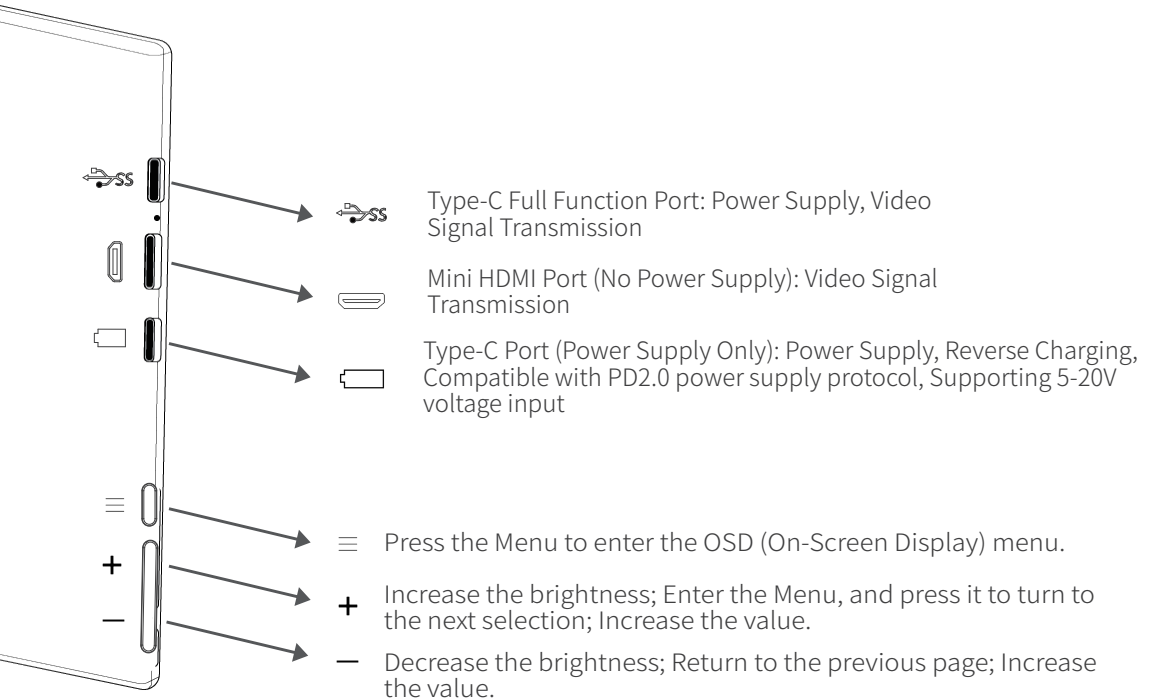

\*It only displays the interfaces and buttons function. Please check the actual machine for the specific position of interfaces and buttons.

# Warning

## Note:

Please handle the triple monitor with care and do not press the screens to avoid damages. Do not unfold it to exceed its maximum turning angle showing as below.

### Turning Angle of Screens

Left Screen(0°-235°)

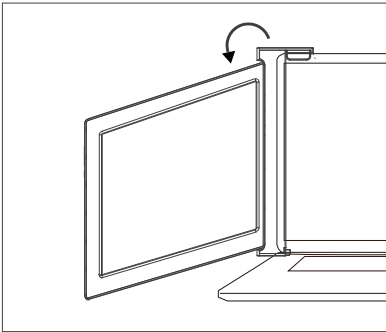

Right screen(0° - 180°)

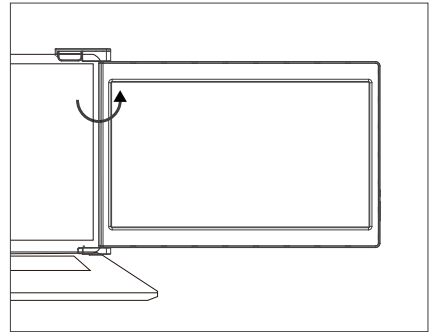

## 4. Set It Up

- 1) Unpack the triple monitor.
- 2) Open two screens in the directions as shown in Fig. 2.
- 3) Place the bracket at the back of the laptop screen and install it well with the bracket clamping the screen firmly.
- 4) Lift up the stand and stretch to its end. Press and hold the button to retract the stand.  
(The stand is embedded at the back of the triple monitor, which can offer extra support to the triple monitor.)
- 5) Using the necessary cables, plug one end of the cable into the triple monitor and the other into your laptop.  
(See “Inputs and Buttons” on page 3 for the input diagram.)

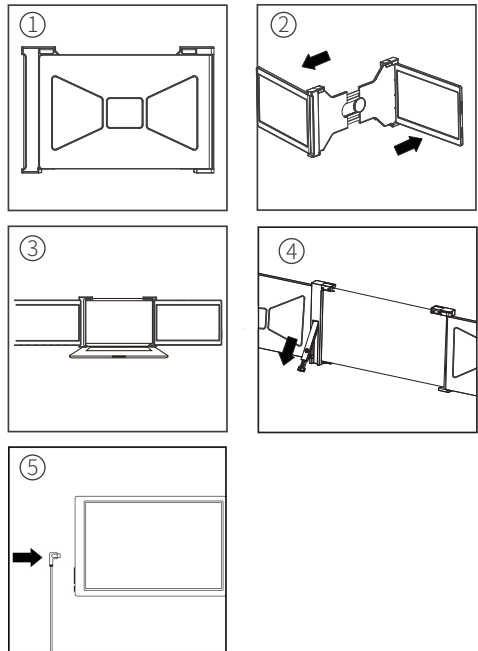



## 5. Connect the Monitor with Your Laptop

### Compatibility of Laptops for the Triple Monitor:

Length: 255-372mm (10-14.6 inch)

Height : >210mm (>8.27 inch)

Thickness: <7mm (<0.28 inch)

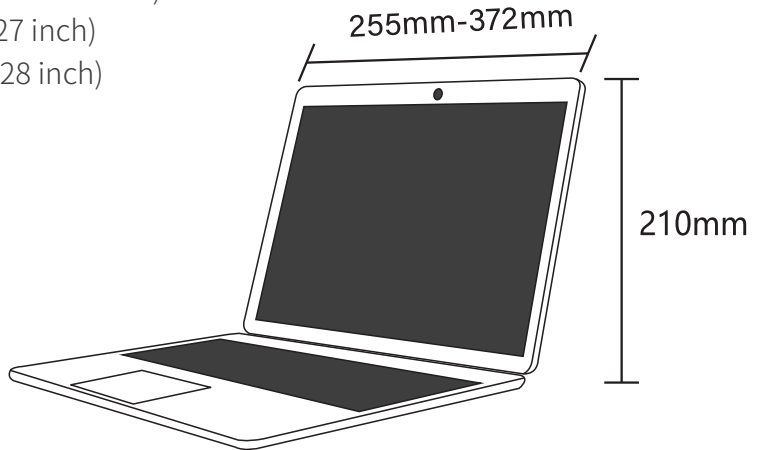

### Notes:

Please measure the length, Height and thickness of the laptop first to make sure it can be compatible with the monitor.

If it is not within this range, please feel free to contact us via the email address [fopo@afterservice.vip](mailto:fopo@afterservice.vip) and we will help you solve the problems as soon as possible.

## 6. Choose Your Cables

### Notes:

To determine which cables you will use, first identify your laptop's ports according to the figure below or your laptop's user manual.

#### VIDEO & POWER:



USB-C 3.1 /  
Thunderbolt 3

#### VIDEO ONLY



HDMI



Displayport



Mini-Displayport



VGA

#### POWER ONLY



USB-A

\*Make sure your USB-C port on the laptop is full-functioned Port. Please refer to your laptop's user manual.

# 7. Connection Methods

## 7.1 Two Type-C or Thunderbolt 3 Ports

There are 2 Type-C or Thunderbolt 3 ports on the laptop.

Use two Type-C cables to connect the laptop with the monitors.

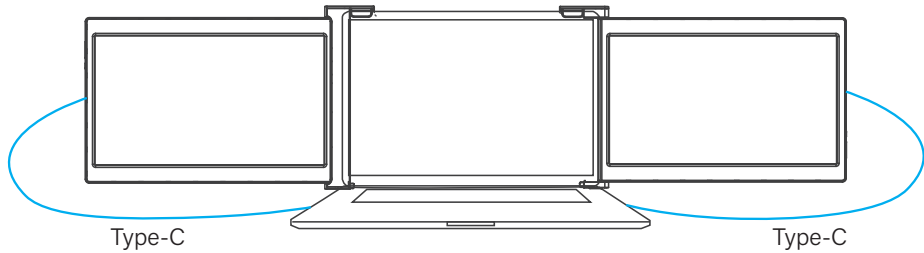

### Notes:

Please make sure that the Type-C port is a full-functioned.

And make sure that the laptop has a power supply.

If you can't connect the monitor with the laptop, please contact us via the email address [fopo@afterservice.vip](mailto:fopo@afterservice.vip), and inform the customer service of the model number of your laptop to quickly determine the compatibility of the connecting port.

## 7. Connection Methods

Some Type-C ports may not be able to transmit currents above 5V/2A, please connect an external power supply to better use the monitor.

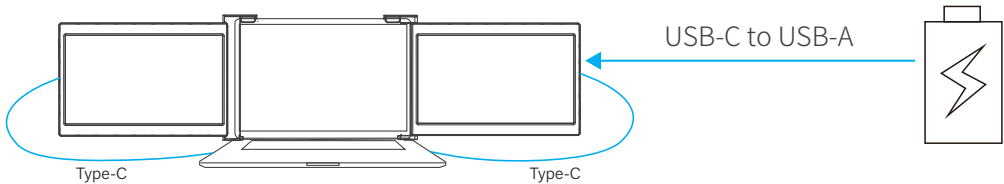

### Notes:

- ① Make sure the Type-C of your laptop is a Full-functioned Type-C port (support both video & data transmission).
- ② Make sure 5V/2A or above power can be supported through Type-C port. An external power supply of 5V/2A or above is needed for normal use (adjust brightness and volume above 50).

If you can't connect the monitor with the laptop, please contact us via [fopo@afterservice.vip](mailto:fopo@afterservice.vip), and inform the Tech. Support of the model number of your laptop to quickly solve your issues.

# 7. Connection Methods

## 7.2 One Type-C and One HDMI Port

There is one Type-C and one HDMI port on the laptop.

- 1) Plug the Type-C cable into Type-C port on one side of the monitor.
- 2) Meanwhile, plug the HDMI cable into the Mini HDMI port on the other side of the monitor.
- 3) And then plug the monitor into the power supply.

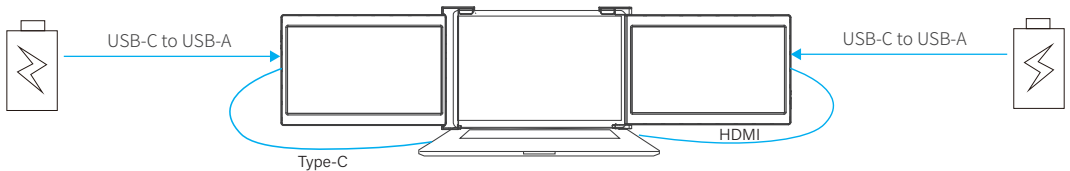

### Notes:

The HDMI port does not provide power, so the monitor must be plugged into the power supply (5V/2A or Above).

# 7. Connection Methods

## 7.3 One HDMI Port

There is only one HDMI port on the laptop.

- 1) Plug the HDMI cable into the Mini HDMI port on one side of the monitor.
- 2) And then plug the monitor into the power supply.

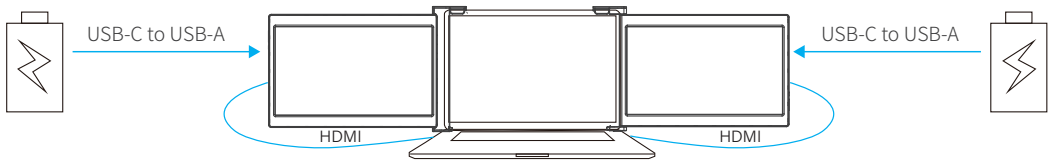



### Notes:

You can contact us via the email address [fopo@afterservice.vip](mailto:fopo@afterservice.vip) for the connection adapter and inform the customer service of the model number of the laptop, and we will find the connection adapter for you. (5V/2A or Above)

# 8. Laptop Display Configuration

## 8.1 PC/WINDOWS

**1. Enter the Display Settings interface.** (Start  > Settings  > System > Display)

**2. Identify the Screen/Set Display Direction**

Click and drag the screens to the configuration shown.

**3. Start Duplication/Extension Setting**

If you need to set different display modes on the triple monitor, please click 1/2/3 (click the “**Identify**” Button down the screen to find the corresponding screen). Select one of them, and then enter into the “Multiple displays” menu to set.

**4. Start Rotation Setting**

If any of the screens are upside down, click the display menu on the screen. Then click the “Orientation” dropdown menu and select “Landscape (flipped)”

**5. Start Scaled Ratio Setting**

To increase the zoom, click the dropdown of “Change the size of text, apps, and other items” and select “150%”.

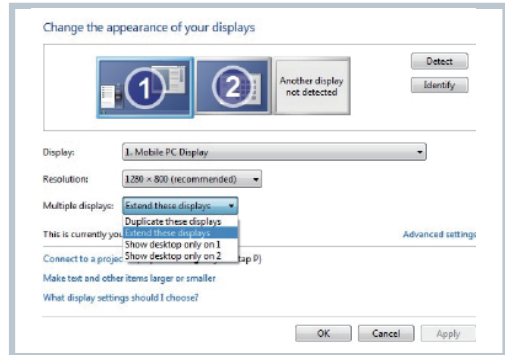
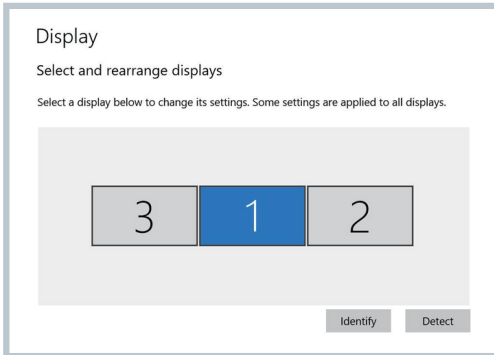

\* In the setting of the graphic card, you can set three displays sync. If you have any problems, please consult the local distributor.

# 8. Laptop Display Configuration

## 8.2 MAC

### 1. Identify the Screen/Display Direction Setting

Open the “System Preferences” . Select “Display” from the menu. And then Click “Arrangement”. Click and drag the screens to the configuration shown.

### 2. Start Duplication/Extension Setting

Duplication Setting: Select “Mirror Display”.

Extension Setting: Cancel “Mirror Display”.

### 3. Rotation Setting

If any of the screens are upside down, click the display menu on that screen and select “180°” from the dropdown.

### 4. Scaled Ratio Setting

To increase the zoom, click the “**Scaled Ratio**” Button.

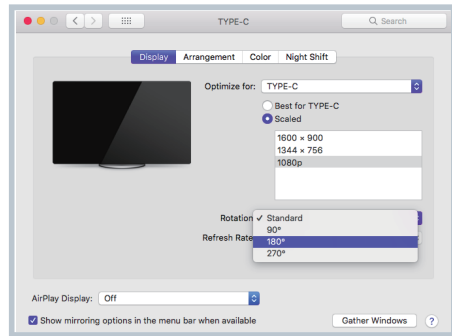
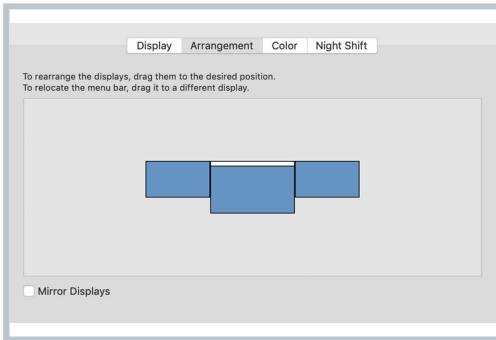



# 9. OSD Function Introduction

1. Press the “≡” Menu button to activate the OSD menu.
2. Press “+” button to choose your settings.
3. Press the “≡” Menu button to confirm.
4. Press “-” button to return to the previous page.



# 10. OSD Setting

## Brightness

Brightness: The adjusting range is from 0 to 100.

Contrast: The adjusting range is from 0 to 100.

Black Level: The adjusting range is from 0 to 100.

Sharpness: The adjusting range is from 0 to 100.



## Image

ECO: Presets the display settings for various modes (Standard/Game/Movie/Text/FPS/ RTS Modes).

DCR: Selects ON or OFF to enable or disable the dynamic contrast ratio function.

Aspect: Adjusts the aspect ratio to 4:3/WIDE.



# 10. OSD Setting

## Color Temp

Color Temp: Enables the adjustment of each RGB color, or select a Warm or Cool preset level.

Red: The adjusting range is from 0 to 100.

Green: The adjusting range is from 0 to 100.

Blue: The adjusting range is from 0 to 100.

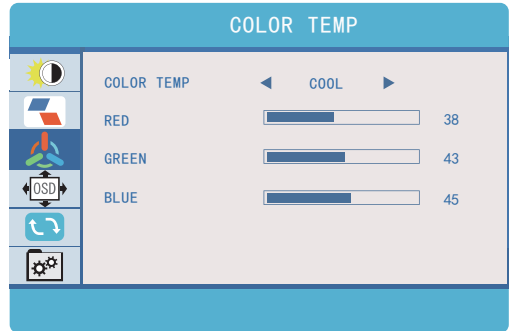

## OSD Setting

Language: Selects OSD language. The selections are as follows, English, French, German, Simplified Chinese, Italian, Spanish, Portuguese, Turkish, Polish, Dutch, Japanese, Korean.

OSD Timer: Sets time-out for monitor settings menu (10-60 seconds).

Transparency: Sets the transparency of monitor settings menus.

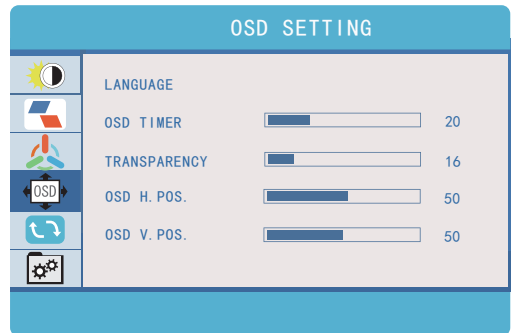

# 10. OSD Setting

## Reset

Reset: Selects **RESET** to revert all settings to the factory default mode.



## MISC

Signal Source:

Contains two signal sources: Type-C and HDMI.

Low Blue Light:

Decreases the amount of blue light in the display.

HDR MODE:

Enables HDR (High Dynamic Range) when connected to a compatible device, with three modes (OFF/Auto/2084).



# 11. Supported Brands & Models

	Brands	Models
MAC	MacBook Air	13 2018, 13 2019
	MacBook pro	13 2016, 13 2017, 13 2018, 13 2019, 13 2020(Intel CPU), 15-inch 2016, 15-inch 2017, 15-inch 2018, 15-inch 2019, 16 2020
Lenovo	IdeaPad	100 Series, 1 (14") Intel, 1 (14", AMD), Flex 5G 14, Flex 5 15 (Intel), Flex 5 14 (Intel), 3 (15") Intel, 3i (15", Intel), Gaming Laptops, 5 (14") AMD, 5 (15") Intel, S540 (13", Intel), Slim 7 (14", Intel), Slim 9
	ThinkBook	13s Gen 2 (13") AMD, 14s Yoga (14") Intel, 14 Gen 2 (14") Intel, 4 Gen 2 (AMD)
	Yoga	9i (15"), 9i (14"), C940 (15"), C940 (14"), 7i (15"), 7i (14"), C740 (14"), C740 (15"), 6 (13"), Chromebook (15.6")
	Legion Y series	Y740 (15"), Y540 (15")
	Legion 5 series	5 Pro Gen 6 (16", AMD), 5 (15", AMD), 5i (15")
	Legion 7 series	7i 15", Slim 7i 15"
HP	HP ZHAN 66	Pro A 14 G4, Pro 15 G3, Pro A 14 G4
	HP ZHAN X	G2 Notebook
	PAVILION	X360 14-DH0003TU, 14, 14-2021
	HP Pavilion Laptop	14t-dv000 touch optional, PC 14-dv0097nr
	ProBook	455 G8, 440 G7, 450 G8, 430 G7
	HP Notebook	14s-cr2003tx, 15s-dy0002tx

# 11. Supported Brands & Models

Brands		Models
	HP Laptop 14s	dq1020nl, dq1041ur, dq1044ur, dq1057nm, dq1062nf, dq1191nb, dq1246no
	Zbook	Zbook, Zbook (AMD R7), Zbook (Intel),
	Victus	Air 15-dk0125TX, 15-dk1116TX
	OMEN	Air 15-dh0006TX PRC (15.6inch), Plus 17-cb0001TX/ 17-cb0002TX (15.6inch), R5 (AMD R7), Pro 15.6inch, 16.1inch, X 15 15-dg0003TX
	ELITEBOOK	735 G6, 745 G6, 830 G6
	Other Models	348 G7
DELL	Inspiron	15, 14 3000 Series, 5000 Urban 14, 5000 Urban 15, 7000 14, 5000 Fit 14, 5410 14
	Latitude	13 3000 Series 2-in-1, 3510, 3520, 3400, 3000 14, 13 5300, 5420, 15 5500, 7420, 13 7000 Series 7390, 7400 2-in-1, 7410, 7520, 14 5401, 12 7000 Series 7290, 9510, 5300 2-in-1
	G Series	G3, G15, G5 15, G7, G3 pro 15, G15 RYZEN Version
	XPS Series	XPS 13, XPS 13(XPS 13-9310-R2508S), XPS 13 2-in-1, XPS 15, XPS 15(XPS 15-9500-R1505S)
	Other Models	Vostro 15 3000 Series
HUAWEI	MateBook	D 15 2021 15", D 15 AMD 15", D 14 2021 14", D 14 AMD 14", B3-510, B5-420, X 2020 13.3", X Pro 2021 13.9", 16 16", B3-410, X Pro 2020, 14 2020 14", 14 2021 14"
	Other Models	Qingyun L410

# 11. Supported Brands & Models

	Brands	Models
ThinkPad	ThinkPad P Series	P15 15.6", P15v 2020 15.6", P1 Gen 3 15.6", P15s Gen 2 15.6", P14
	ThinkPad T Series	T14 2021 14", T490 14", T15 15.6", T14s 2021 14", T15P 15.6", T590 15.6"
	ThinkPad X Series	X1 Extreme Gen1 15.6", X1 Nano 13", X13 13.3", X1 Yoga 2020 14", X1 Titanium Yoga 13.5", X390 Yoga 13.3"
ASUS	ASUS	K505BP9225, FL8700
	Vivobook	R424, 6S, 15X 2020, 7 14 2021, X Radeon, 14, V4000, 15X 2020,
	TUF Gaming	9, FA506, 8, FA506II, 2, 2 Cori, air, FA506IV, FA506IU
	Zenbook	14, X dual screen, X2 Duo, S Flip, X S, X Fone, X2 Pro, G15
	Other Models	Pro 14, Mars 15
SAMSUNG	Galaxy Book	Flex
	Xingyao	950XBE, 930MBE, 930SBE, 930MBE
ACER	Acer	TMB118-M-P268, Swift3, Fun, P50, Fun+, P40, X 14", TMP414 14", TMX40 14"
	EX Series	215-52-53UZ, 214-51G-59WV, 215-51-5826, 215-51-50YZ, 215-51G-550A, 214-51-56YK, 214
	S Series	S3X, S3, S40-51-54WR, S50-51, S5 14
	TMP Series	50-51-83Z1 15.6", 40-52-74VZ 14"

# 11. Supported Brands & Models

	<b>Brands</b>	<b>Models</b>
	Other Models	Young, SF114-32-C8H2, SF314-41-R0X8, Shadowrider15.6", Shadow Knight Dragons 15.6", Concept D 3 15.6", SF515-51T-71QD 15.6", Travel Mate P6 14", TMX45-51-53RW 14", TMX514-51-50PJ 14", Predator Blade 500 15.6", Concept D 7 Ezel 15.6", Book RS 14"
LG	gram	14 2020 14", 15 2020 15.6", 16 2021 16", 14 2021 14"
	More Brands	Update Continuously



## 12. Tech Specs

### Display

- Power Consumption: 5V 2A
- Adaptive Laptop Dimensions: 12 inch
- Resolution: 1920\*1080
- Panel Type: Full HD LCD IPS Panels
- Aspect Ratio: 16:9, 4:3
- Brightness: 220-350 cdm<sup>2</sup>
- Contrast Ratio: 800:1
- Surface Treatment: Anti-Glare
- Display Color: 262k Colors
- Color Gamut: 74% (NTSC)
- Response Time: 25ms/30ms
- Working Frequency: 60Hz

### Inputs and Connectivity (Per Screen)

- Thunderbolt3/USB-C 3.1 Input  
(Video and Power)
- Mini-HDMI Input (Video Only)
- USB-C Input (Power Only)

### Size and Weight

- Length (Left to Right):  
255-372 mm (10-14.6 inch)
- Height (Top to Bottom):  
>210 mm (8.27 inch)
- Thickness (Display Panel):  
< 7 mm (0.28 inch)
- Weight: 2.58 lbs/1.17 kg
- Dimensions: 318 x 215 x 25 mm  
(12.52 x 8.46 x 0.98 inch)

## 13. Cleaning & Maintenance

1. Cleaning: Please use a screen wiping cloth to clean the monitor. And do not connect the monitor to the computer when cleaning.
2. Please don't use cleaning tools containing alcohol/acid substances to wipe the screen.
3. You may find slightly uneven brightness on the screen depending on the desktop pattern you use.
4. When the same image is displayed for hours, an afterimage of the previous screen may remain after switching the image. The screen will recover slowly or you can power it off for hours.
5. When the screen becomes black or flashes, or cannot work anymore, please contact us via the email address [\*\*fopo@afterservice.vip\*\*](mailto:fopo@afterservice.vip) for help. Do not repair the screen by yourself!

## 14. Contact Us

If you need any help, please don't hesitate to contact us via the email address **fopo@afterservice.vip** and we will help you solve the problems as soon as possible.

Get 24/7 assistance at



Use camera or QR scanner to scan

Or Visit: <https://fopo.afterservice.vip>